

目錄 Contents



切碎機

CUT MILL

01

破碎機

CRUSHER

03

中碎機

FITZ MILL

07

角柱型粉碎機

PIN MILL

09

輕量型微粉碎機

MICRON PULVERIZER

11

空氣分級超微粉碎系統

ACM Ultra Fine Pulverizer System

19

空氣分級超微粉碎系統 - 集塵機活動型 Movable Bag Filter

ACM Ultra Fine Pulverizer System

27

氣流式粉碎機

JET MILL

28

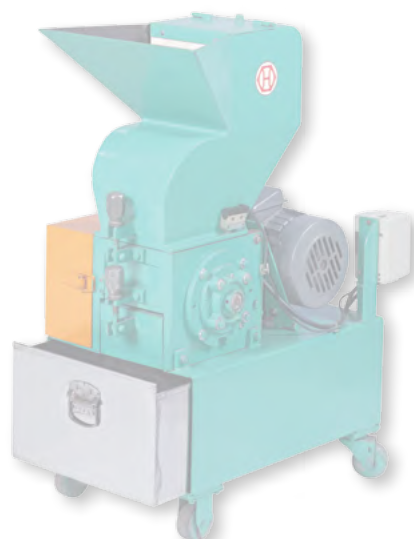

切碎機 CUT MILL

此機是利用粉碎室兩邊的固定刀與滾軸上各式排列切爪刀，對粉碎物作剪切式破碎功能。對韌性及有纖維質的物料最適合。如塑膠、橡膠、木材、中藥材…等，是一種好操作、高效率、用途廣，堅固耐用的破碎設備。

This machine is using the fixed blade on both sides of grinding room and all kinds prearranged claw knife on the roller, to cut and crush the object to be broken. It is most suitable for the material with toughness and containing fiber materials, such as plastic, rubber, wood, traditional Chinese medicine ... etc. It is a good operation, high efficiency, wide application, robust and durable breaking equipment.

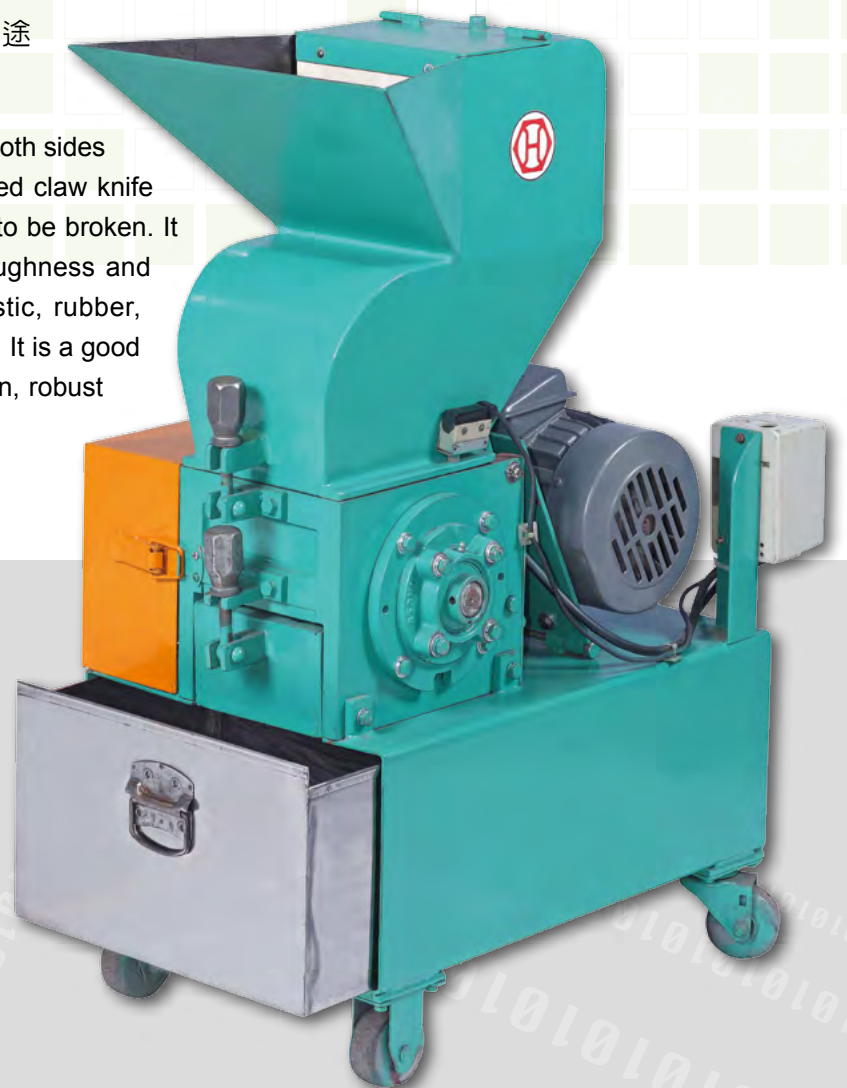

外型圖 Outline diagram

直接收料

Direct material receiving

次料回收組合

Sub-material recycling assembly

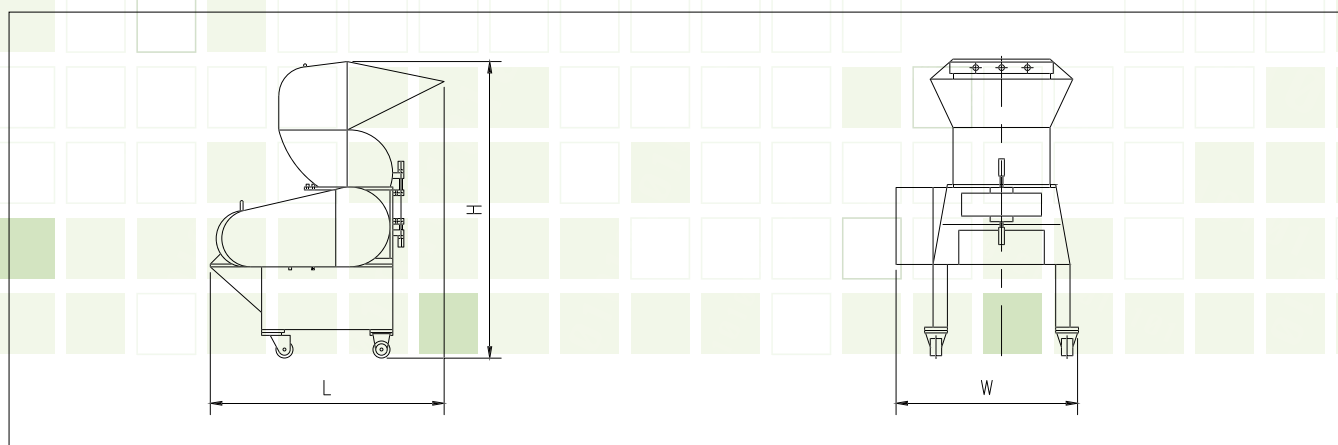
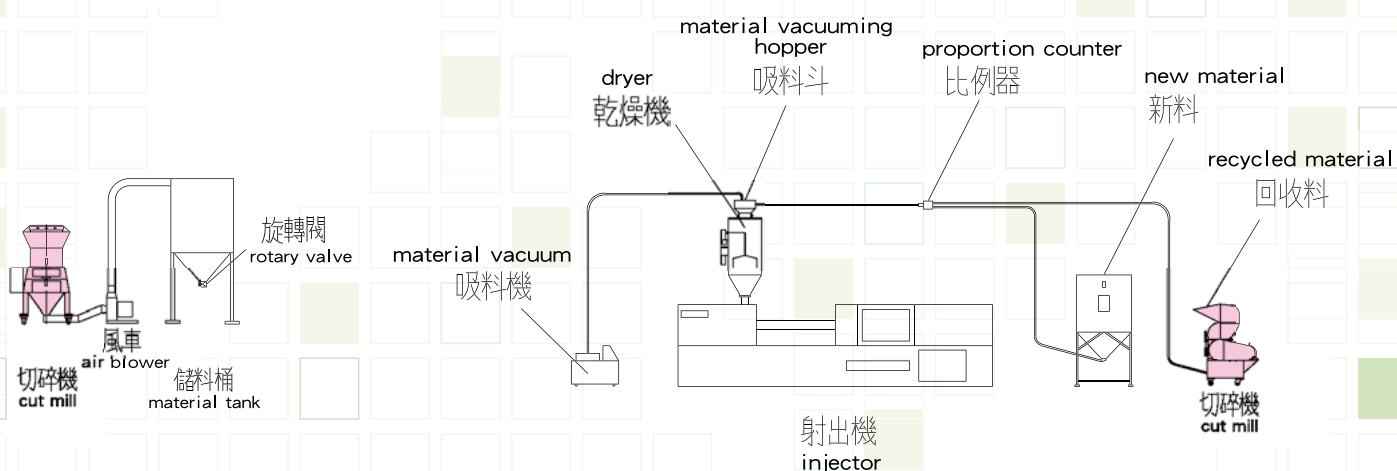

規格表 Specification table

型式 規格 Model Specifications		CM-01	CM-02	CM-03	CM-04	CM-05	CM-06	CM-07	CM-08	CM-09	CM-10	CM-11	CM-12
馬力 HP	HP	1	2	3	5	7 $\frac{1}{2}$	10	15	20	30	50	75	100
轉速 RPM	RPM	330	480	540	540	640	635	530	600	600	610	610	610
入料口徑 Material feed size	m m	150 x 200	250 x 200	300 x 200	320 x 220	380 x 240	380 x 240	450 x 320	560 x 400	560 x 400	760 x 600	1000 x 750	1250 x 750
固定刀片 Fixed blade	PC	2	2	2	2	2	2	2	2	2	2	2	2
活動刀片 Movable blade	PC	9	15	18	6	6	9	9	9	9	9	12	15
概略尺寸 Approximate dimension	L	640	830	830	1270	1390	1390	1650	1760	1760	2250	2250	2250
	W	370	530	580	720	850	850	890	1080	1080	1450	1690	1690
	H	850	1080	1080	1220	1450	1450	1640	1960	1960	2420	2420	2420
概略重量 Approximate weight	KGS	120	250	280	460	560	580	900	1800	1800	3000	3200	3200



破碎機 Crusher

破碎機是一種利用滾筒固定排列刀經滾筒轉動力量，強制破解粉碎物的設備，對假性結塊之破碎最適用，可作為單機使用或搭配細碎前製程粗碎處理使用，除規格尺寸外，可依使用狀況量身訂製，包括進出口口之大小及排列刀及檔板之型式。

Crusher is a device in which a series of cutters fixed on a roller force the crushing objects via the rotation of roller. It is most effective for crushing lumps, and therefore suitable for using as a single unit or the preprocessing unit in a manufacturing process. The crusher can be customized, including the size of feeder and what type of cutters and guard plate, expect specific dimensions.



外型圖 Outline diagram

搭配超微粉碎系統 ACM Ultra Fine Pulverizer System

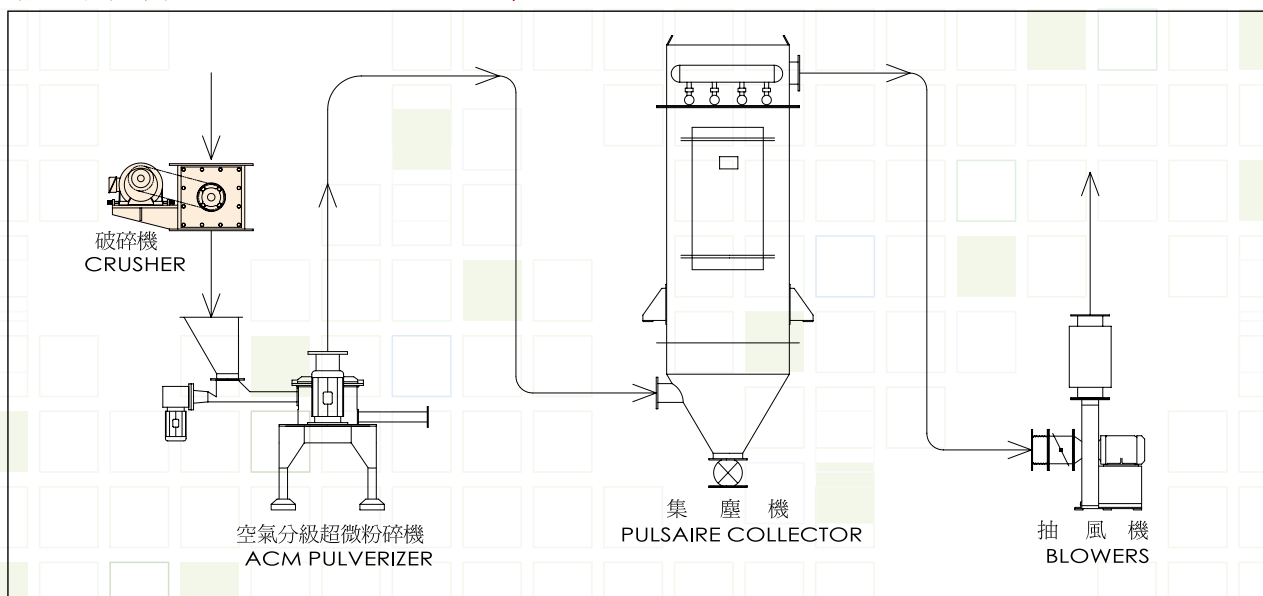

尺寸圖 Dimension diagram

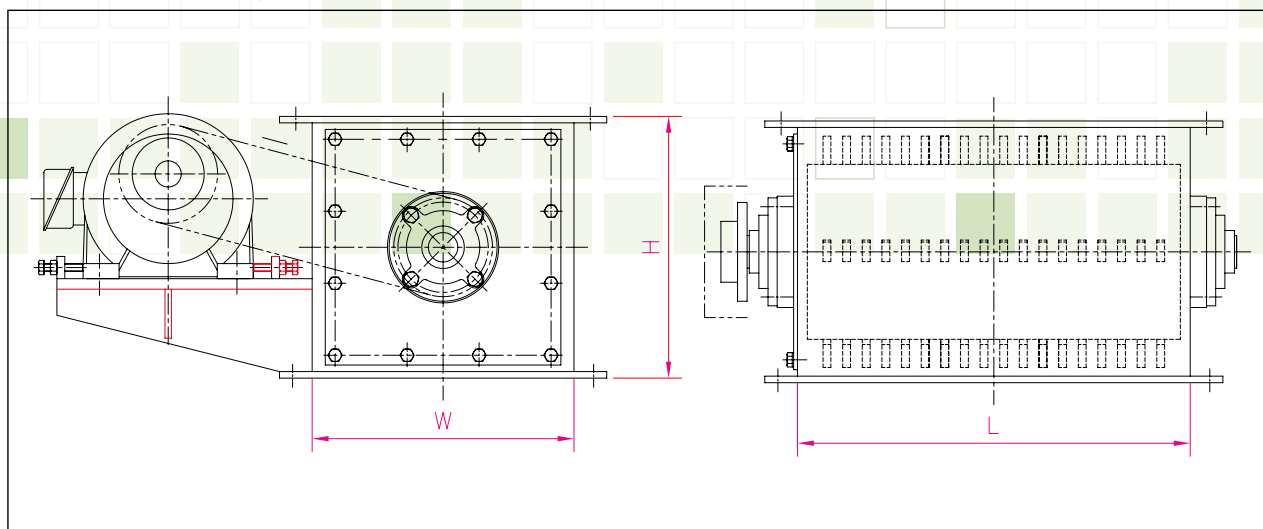

破碎機規格表 Specifications for horizontal crusher

型式 規格 Model Specifications		CR-01	CR-02	CR-03	CR-04	CR-05	CR-06	CR-07	CR-08	CR-09	CR-10
馬力 Horse Power	HP	0.5~1	1~2	1~2	2~3	2~3	3~5	5~7.5	7.5~10	10~15	15~30
迴轉速 RPM	RPM	3000	2100	1600	1300	1100	850	700	600	500	450
概略尺寸 Roughing-in dimension (mm)	L	150	250	300	330	400	550	600	750	800	900
	W	100	150	200	220	250	350	400	500	550	600
	H	100	150	200	220	250	350	400	500	550	600



CR-2

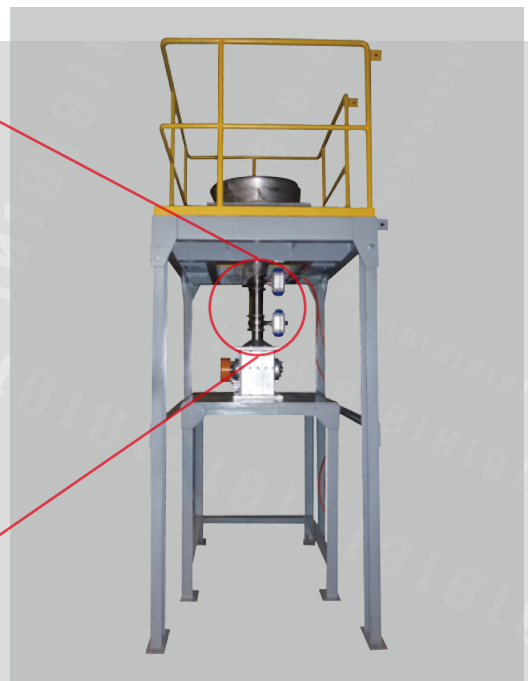
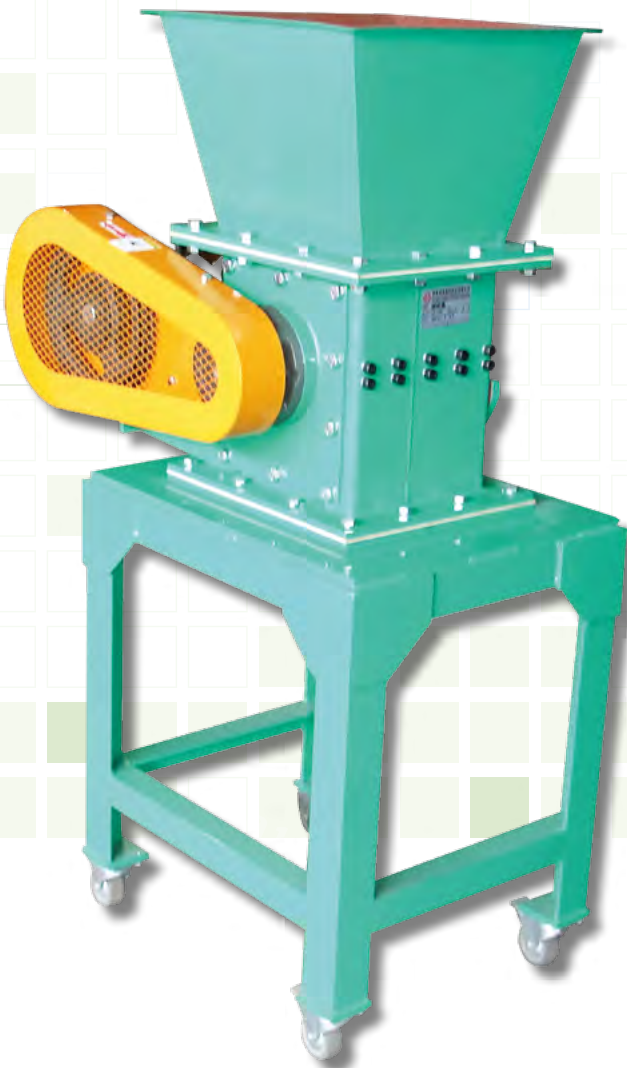

CR-5

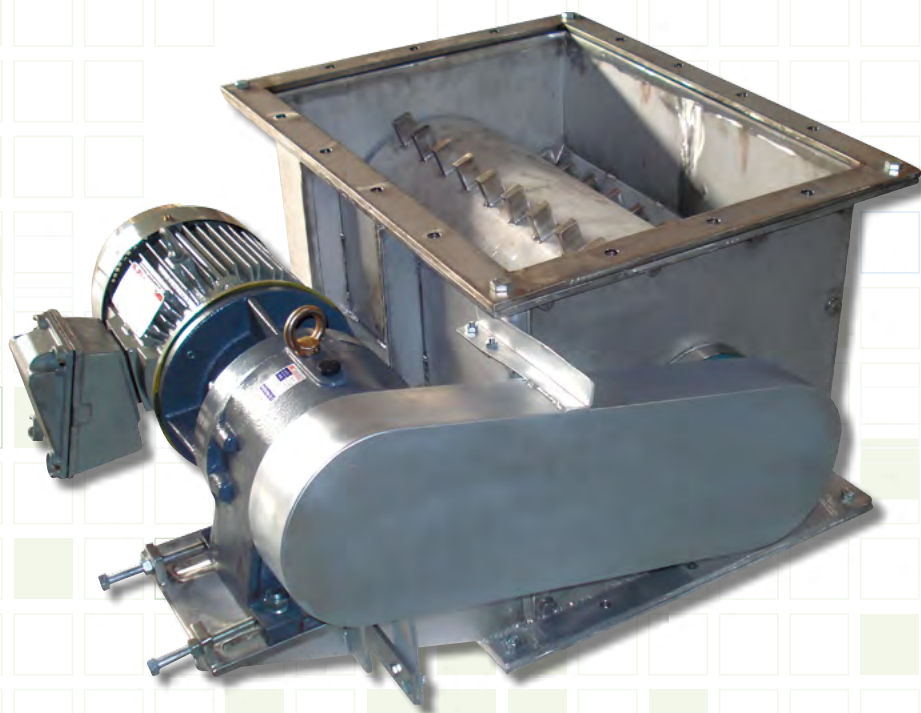

CR-7





中碎機 FITZ MILL

此機是以轉動軸上裝配各式的固定刀錘，直接對粉碎物衝擊，再配以各式濾網而達到粉碎、整粒、解碎之目的。粒度大小及形狀可隨網孔及轉速而調整，其特性為產生的微粉量少、粒度均一，且不太會發熱，亦可作乾、溼兩用粉碎，是一部兼多項功能的粉碎設備。

This machine is using various fixed blade hammer installed on the rotating shaft, to hit directly on the crushed material, incorporated together with various screen to achieve target of crushing, shaping, decomposing. The particle size and shape can be adjusted by mesh and speed. The feature is to generate less small powder with uniform particle size, and less heat. It is suitable for both wet and dry grinding and is multipurpose grinding equipment.

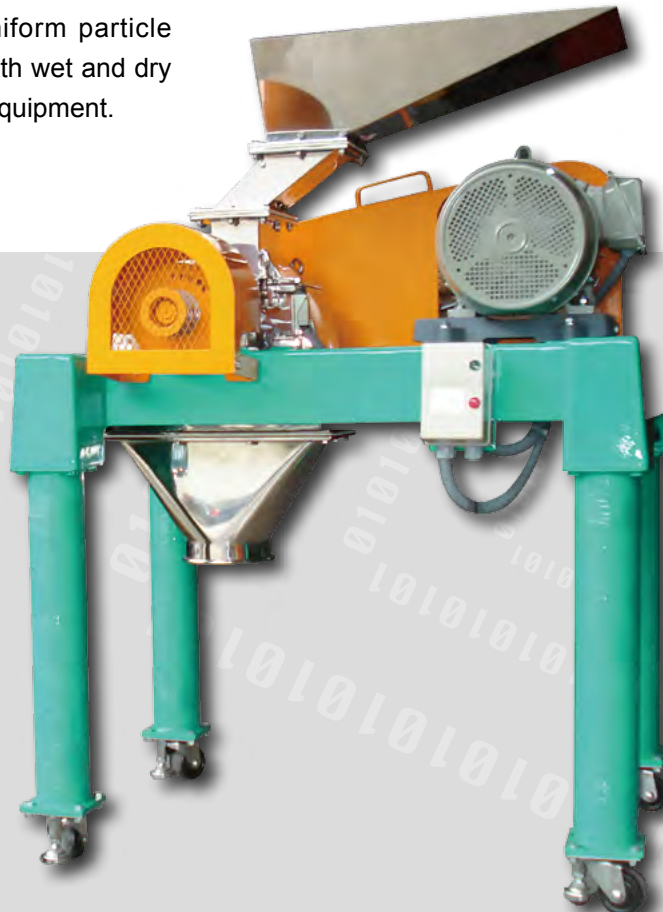

外型圖 Outline diagram

尺寸圖 Dimension diagram

網板型式 Sieve patterns

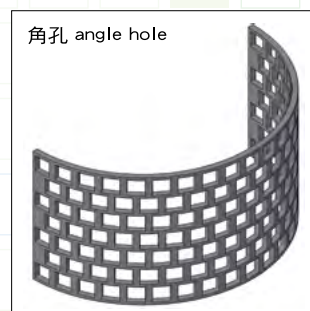
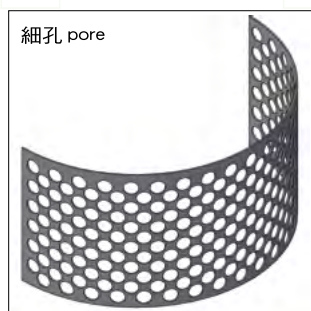

刀錘型式 Knife hammer type

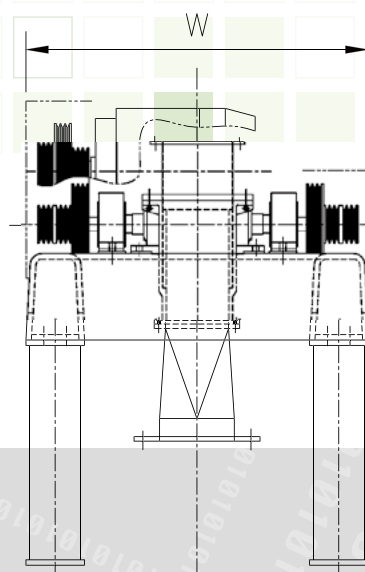
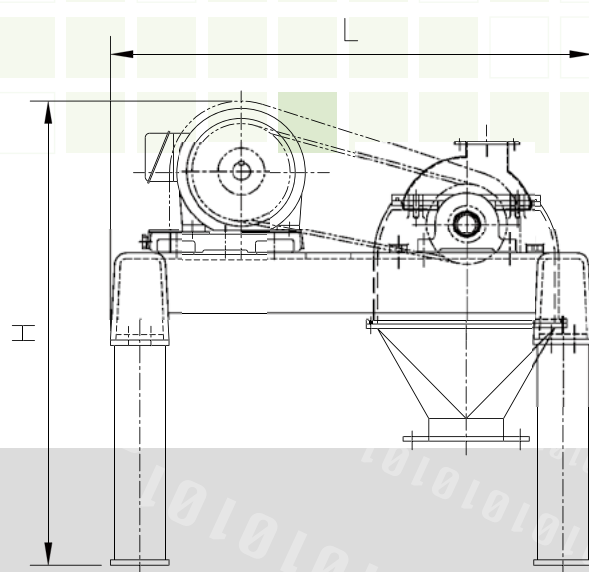

規格表 Specification table

型式 Model	馬力 HP	轉速 Rpm	刀錘數 Number of cutters	概略尺寸 Approximate dimension L×W×H	概略重量 Approximate weight KGS
FM-01	5~7 $\frac{1}{2}$	1000~4600(60HZ) 800~3800(50HZ)	16	1070×760×1030	350
FM-02	10~15	1000~4600(60HZ) 800~3800(50HZ)	32	1200×850×1200	450

可依生產需要製造更大型規格 May manufacture larger size according to production demand.

角柱型粉碎機

PIN MILL

此機為外蓋固定齒環與軸心盤的活動齒環交錯排列，經主軸高速旋轉而產生相互衝擊、剪切、磨擦等綜合作用，使物料得到粉碎效果，再經過篩網後可得一定細度粉體。針對不同物性，齒狀可設計成角柱式和針棒式。機體外殼可加裝水套做冷卻功能，是一種多功能、高效率、堅固耐用的粉碎設備。

In this unit, the fixed rim of exterior cover and the moving rim of shaft disc align alternately, and the shaft rotates in high speed creating impacts, cutting and grinding effects, allowing the material to be crushed into powdery consistency. The crushed material then goes through sieves in order to obtain the desired granular size. Depending on the physical natures, the teeth can be designed as cylinders and needles. The casing of the unit can be installed with water bath for better cooling. This is a multifunctional and durable milling system of high efficiency.



外型圖 Outline diagram

尺寸圖 Dimension diagram

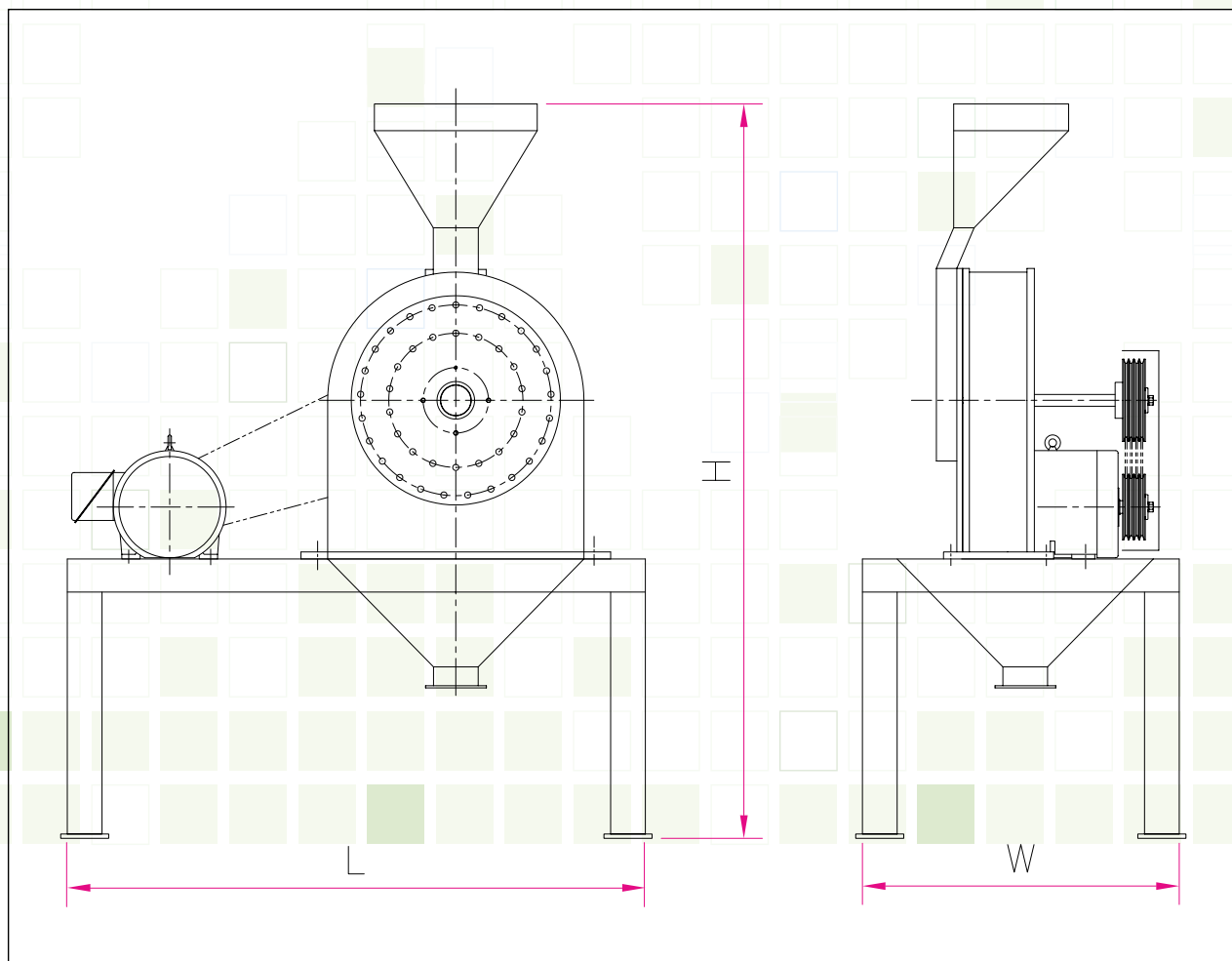

柱式粉碎機規格表 Specifications for PIN MILL

型式 Model		PIN-01	PIN-02	PIN-03	PIN-04	PIN-05	PIN-06	PIN-07
規格 Specifications								
馬力 Horse Power	HP	1	3	5	$7\frac{1}{2}$	15~20	30~40	50~60
迴轉速 RPM	RPM	3500	3500	3500	3200	3000	2900	2700
概略尺寸 Roughing-in dimension (mm)	L	500	800	1100	1200	1500	1700	1900
	W	560	600	700	800	900	1000	1300
	H	1300	1500	1600	1800	2200	2400	2900

備註：網板孔徑視粉碎細度而調整

Note: the diameter of mesh holes is adjustable according to the desired granular size.

輕量型微粉碎機

Micron Pulverizer

高度可轉性的粉碎機與較大型粉碎機有相同而顯著的特色和優點，微粉碎機能使較大型粉碎機運轉倍增，故而能使精確的計畫生產成為可能。微粉碎機的製造標準與其他粉碎機相同。標準化的小型微粉碎機有一驅動輸送螺旋的馬達，非但平均能力很高，而且視原料的純度，每小時能達到 50 公斤。華穎小型微粉碎機只需一個 0.75 千瓦的驅動馬達和一個螺旋輸送機用 65 瓦的馬達即可。

This highly versatile mill has the same outstanding features and advantages of the larger HUA-YIN Micron Pulverizes. The Performance of the larger Pulverize can be duplicated by the Bantam, thus, making is possible to exactly plan production. The Bantam is manufactured to the same standard as all other Pulverizes. The standard HUA-YIN Micron-Bantam comes with a motor driven feed screw. The average capacities are high and depending on material fineness can go high as 50 Kg/Hr. The HUA-YIN Micron-Bantam utilizes a 0.75 kw main drive motor and a 65 watt motor for the feed screw.

● 主要零組件 (MAIN ASSEMBLY PARTS)



外型圖 Outline diagram

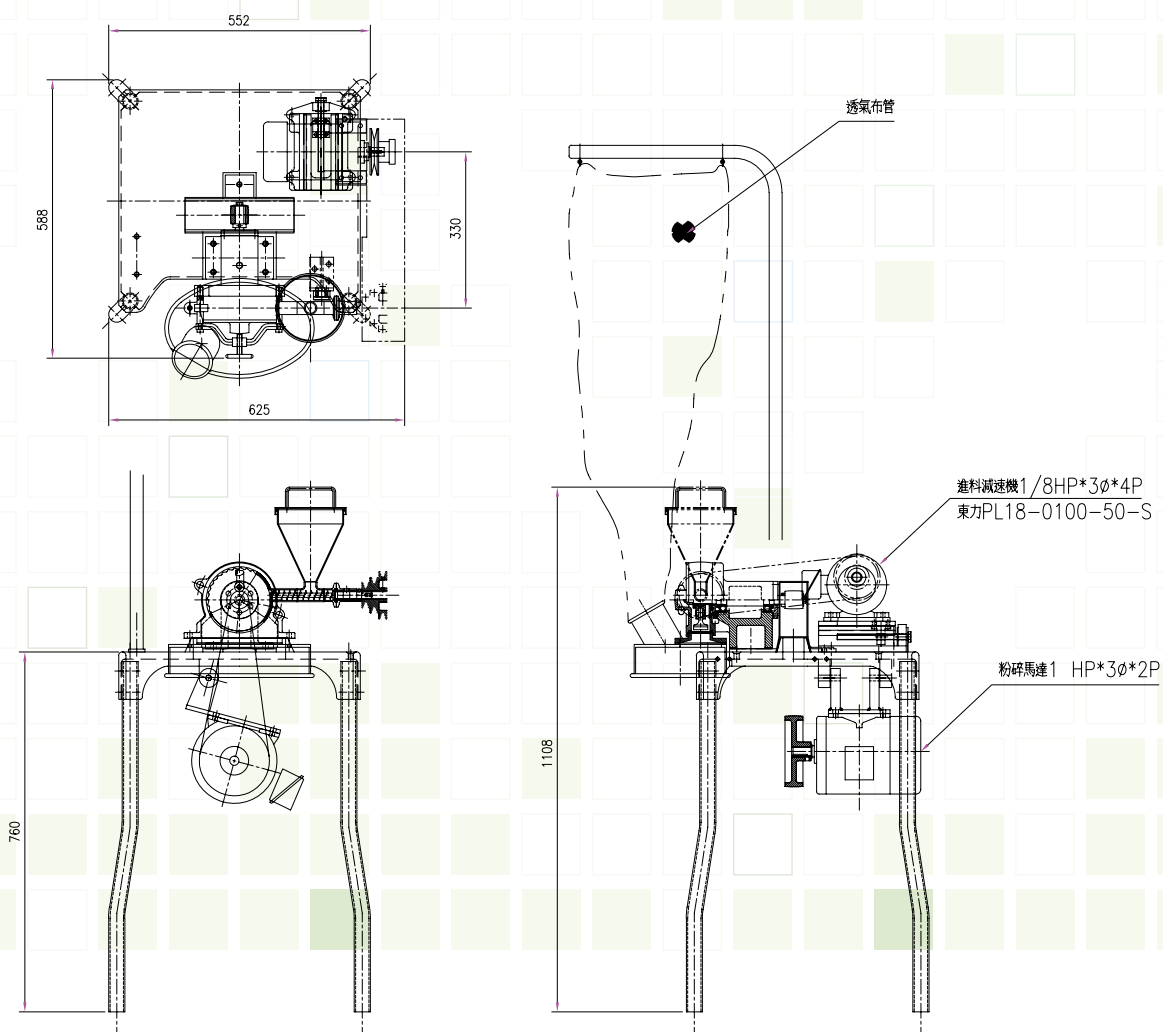

適用能力例 (TYPICAL PERFORMANCE)

原料 MATERIAL	型式 MODEL	能力 CAPACITY (Kg/Hr)	製品 PRODUCT (Mesh)
活性炭 Active Carbon	MP-2	220	95% pass 250
杏仁食物 Almond Meal	MP-1	290	77% pass 60
礬土氧化物 Aluminum Fluoride	MP-1	140	94% pass 250
動物飼料 Animal Feed	MP-4	2000	Almost pass 40
香蕉乾燥品 Dried Banana	MP-B	95	97% pass 100
大麥 Barley	MP-2	105	95% pass 100
咖啡因 Caffeine	MP-1	190	99% pass 40
碳酸鈣 Calcium Carbonate	MP-2	800	99% pass 100
氫氧化鈣 Calcium Hydroxide	MP-1	67	89% pass 300
碳煙 Carbon Black	MP-4	1000	Size reduction of grit
石灰 Chalk	MP-4	2700	99% pass 325
無煙煤 Coal, Anthracite	MP-2	350	96% pass 100
可可亞 Cocoa	MP-2	800	93% pass 100
澱粉 Corn Starch	MP-4	5350	Almost pass 200
魚飼料 Fish Meal	MP-2	300	90% pass 80
粒狀砂糖 Granule Sugar	MP-2	190	98% pass 300
白陶土 Kaolin	MP-4	1930	99% pass 200
顏料 Pigment	MP-2	200	Almost pass 300

NOTE: The above figures should be used only as estimates. Every material will necessarily give the same results.



MP-1

●標準規格及尺寸 (STANDARD SPECIFICATIONS AND DIMENSIONS)

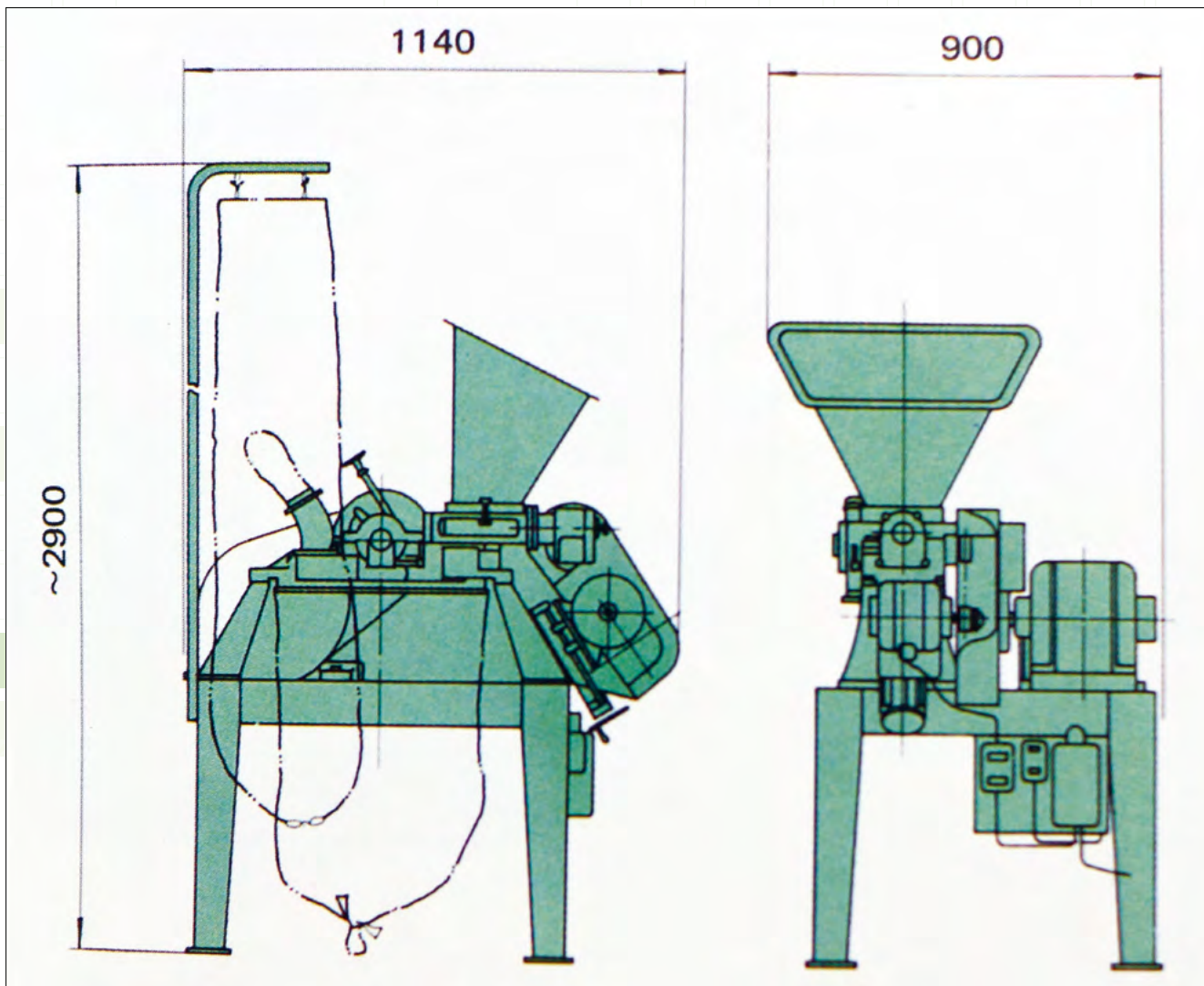

●標準規格 (STANDARD SPECIFICATIONS)

動力需求 POWER REQUIRED	粉碎 MAIN	3.7 kw	大約重量 APPROX. WEIGHT	270 kg
	供料 FEEDER	0.2 kw	擊鎚數量 NUMBER OF HAMMERS	6 pcs.
旋轉數 REVOLUTION	粉碎 MAIN	9,600 r.p.m.	送料機減速比 REDUCTION RATE FOR FEEDER	1/5, 1/10, 1/20
	供料 FEEDER	50~76 r.p.m.(50Hz) 60~91 r.p.m.(60Hz)	儲料斗容積 HOPPER CAPACITY	22 liters

MP-2

●標準規格及尺寸 (STANDARD SPECIFICATIONS AND DIMENSIONS)

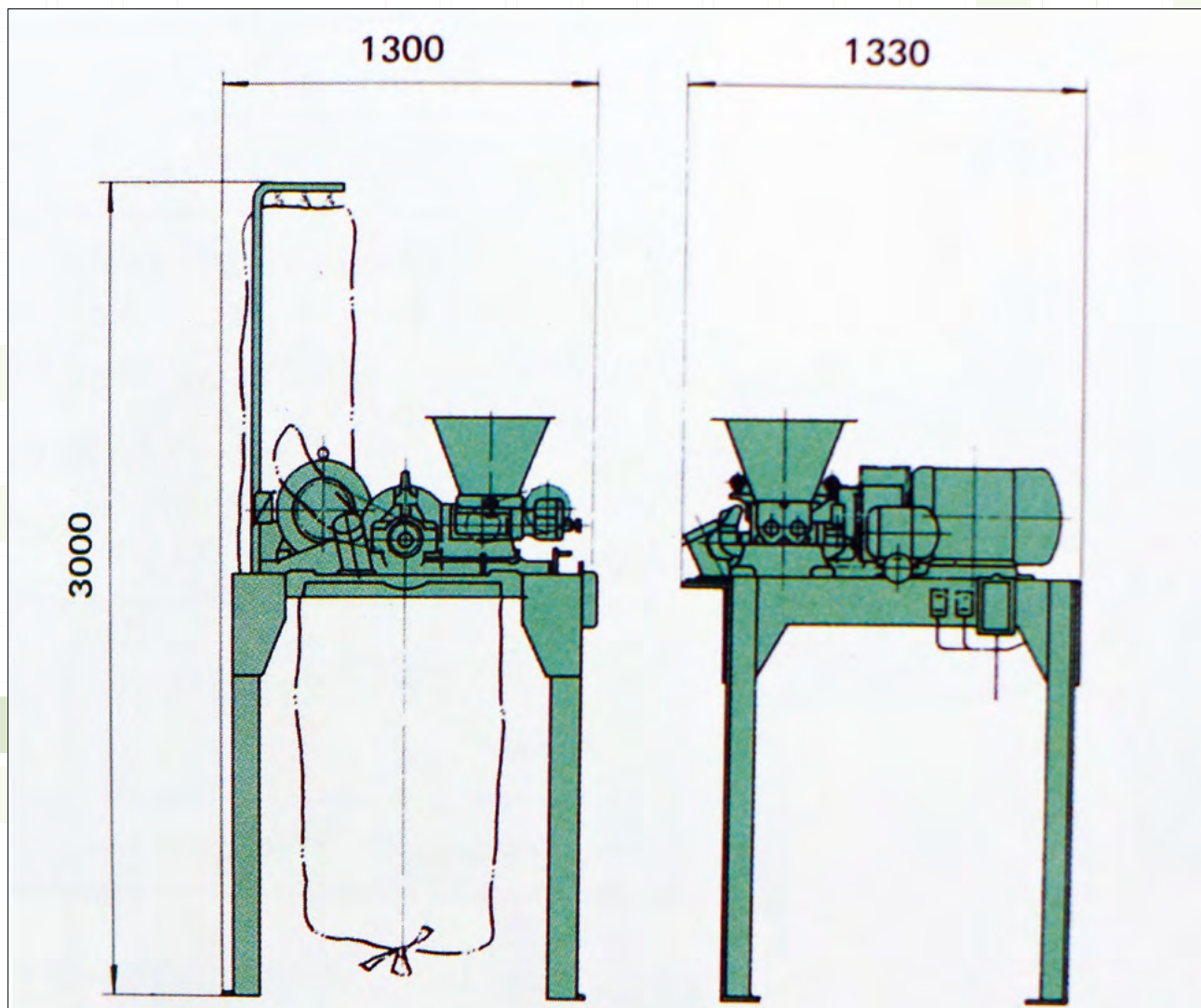

●標準規格 (STANDARD SPECIFICATIONS)

動力需求 POWER REQUIRED	粉碎 MAIN	5.5~11 kw	大約重量 APPROX. WEIGHT	630 kg
	供料 FEEDER	0.4 kw	擊鎚數量 NUMBER OF HAMMERS	24 pcs.
旋轉數 REVOLUTION	粉碎 MAIN	6,900 r.p.m.	送料機減速比 REDUCTION RATE FOR FEEDER	1/5, 1/10, 1/20
	供料 FEEDER	61~97 r.p.m.(50Hz) 73~118 r.p.m.(60Hz)	儲料斗容積 HOPPER CAPACITY	25 liters

MP-3

●標準規格及尺寸 (STANDARD SPECIFICATIONS AND DIMENSIONS)

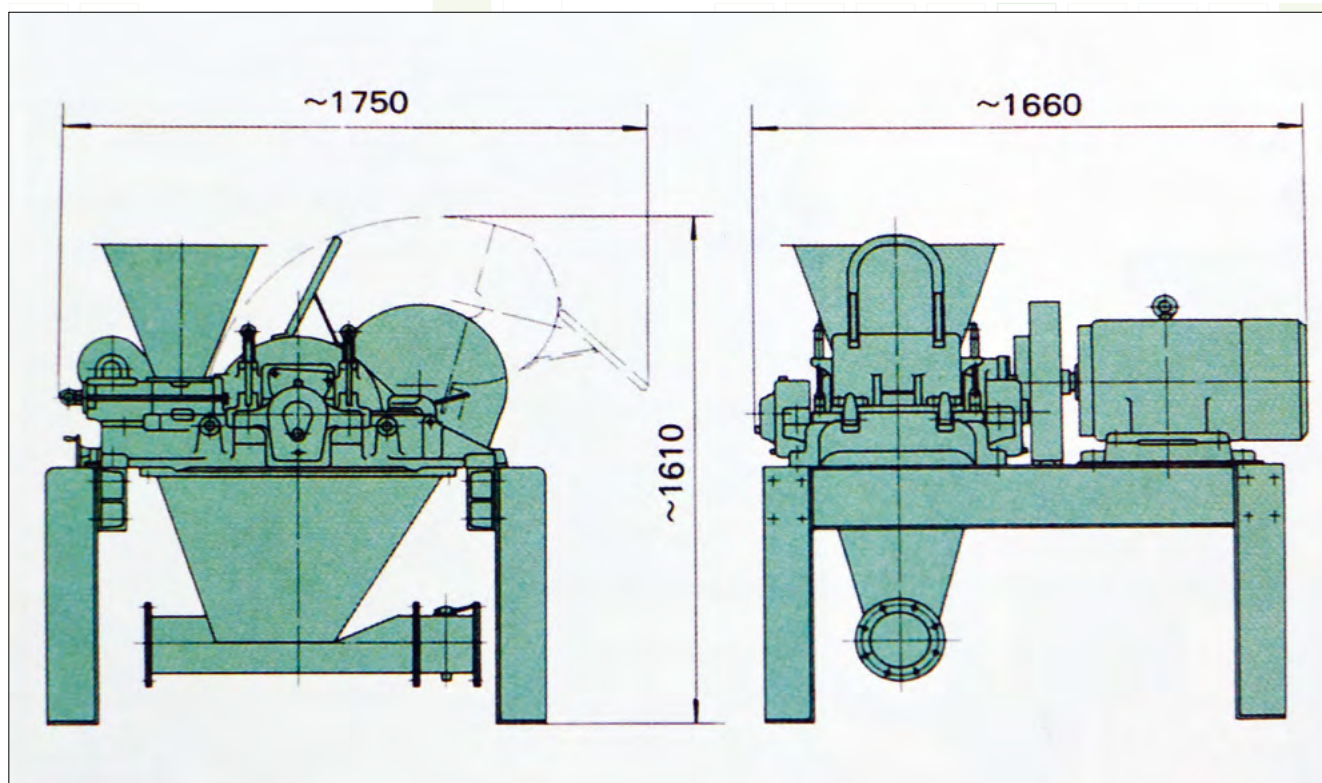

●標準規格 (STANDARD SPECIFICATIONS)

動力需求 POWER REQUIRED	粉碎 MAIN	15~30 kw	大約重量 APPROX. WEIGHT	1300 kg
	供料 FEEDER	0.75 kw	擊鎚數量 NUMBER OF HAMMERS	24 pcs.
旋轉數 REVOLUTION	粉碎 MAIN	4,600 r.p.m.	送料機減速比 REDUCTION RATE FOR FEEDER	1/7.5, 1/15, 1/30
	供料 FEEDER	55~77 r.p.m.(50Hz) 67~93 r.p.m.(60Hz)	儲料斗容積 HOPPER CAPACITY	66 liters

MP-4

●標準規格及尺寸 (STANDARD SPECIFICATIONS AND DIMENSIONS)

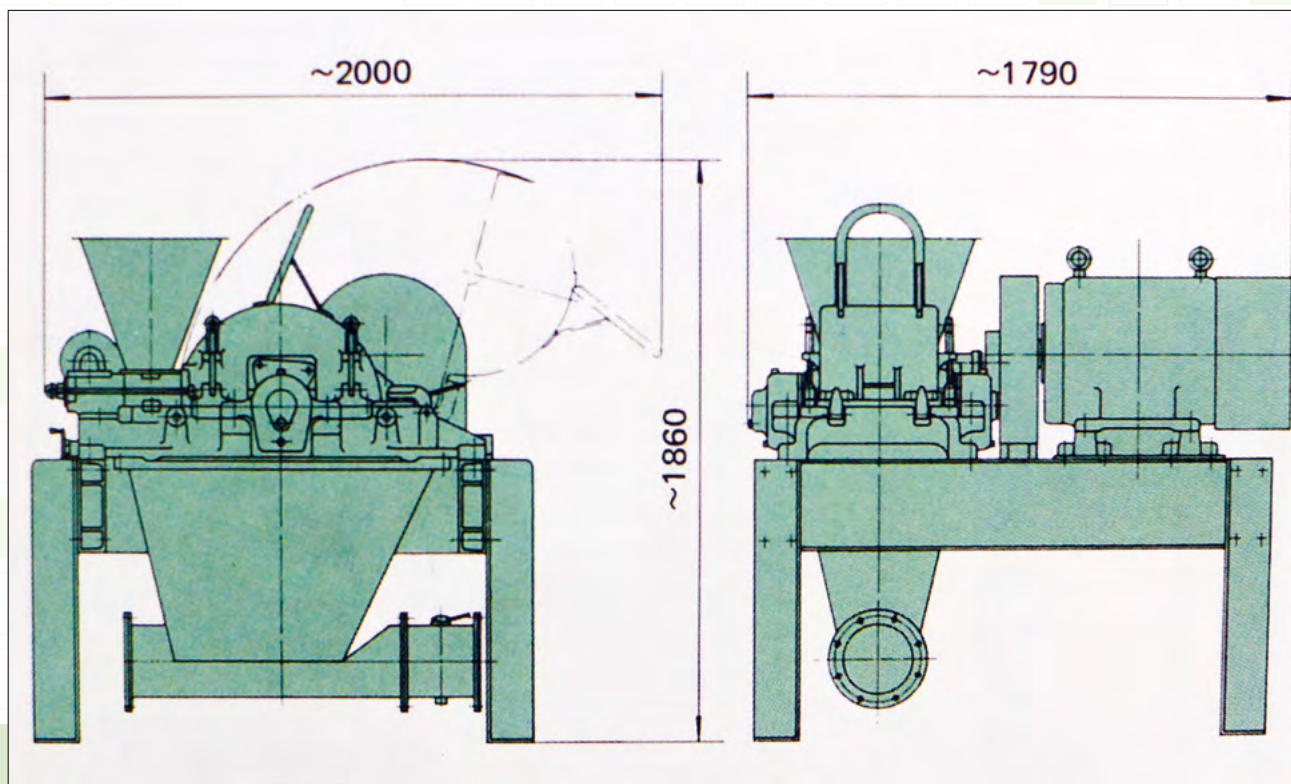

●標準規格 (STANDARD SPECIFICATIONS)

動力需求 POWER REQUIRED	粉碎 MAIN	30~55 kw	大約重量 APPROX. WEIGHT	1900 kg
	供料 FEEDER	0.75 kw	擊鎚數量 NUMBER OF HAMMERS	24 pcs.
旋轉數 REVOLUTION	粉碎 MAIN	3,450 r.p.m.	送料機減速比 REDUCTION RATE FOR FEEDER	1/7.5, 1/15, 1/30
	供料 FEEDER	55~77 r.p.m.(50Hz) 67~93 r.p.m.(60Hz)	儲料斗容積 HOPPER CAPACITY	66 liters

輸送螺旋 Feed Screws

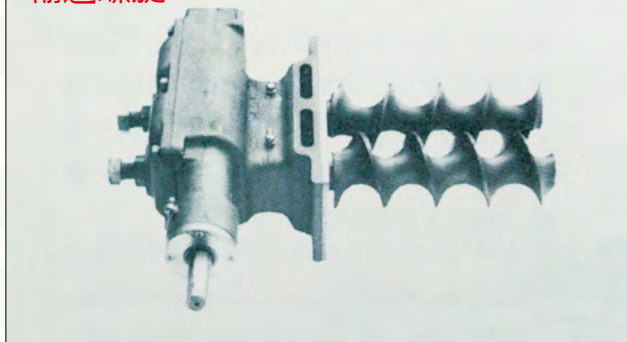

變化極大的輸送螺旋由單一型及複合型所構成，圖例即為這種輸送螺旋之一。這單元乃設計做為運送原料之用。同時為了減少龐大而柔軟的塊狀原料適應粉碎機尺寸而扮演粗粉碎的角色。其他輸送螺旋則其功能在最短時間內移動數量龐大的原料。

Feed screws are constituted of assemblies in unitary type and multi types for wide variations of applications. One of the feed screws assembly is shown in the figure. This unit is designed to feed the raw materials. Meanwhile, it plays a role as coarse grinder for size reduction of caked raw materials in soft texture and hefty volume. As for other feed screws, their function is to move considerable volume of raw materials in a shortest period of time.

複合式傾斜排列刀 Multiple Deflector Liners

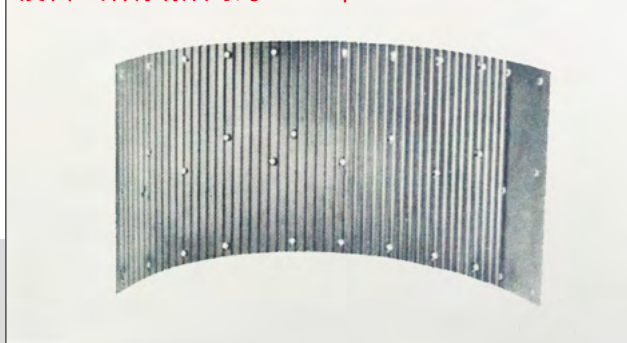

圖例這是一套在粉碎室內高速旋轉的衝擊器。螺旋進入時衝擊原料。這些傾斜的擊鎚附有經久耐用的抗磨蝕合金。棒狀擊槌只需在遇到最少量的細原料時才使用。衝擊型擊鎚則使用在需要超微粉碎時才使用。

The multiple deflector liners for high-speed gyration inside the grinding chamber is shown in the figure. It will gyrate forward to impact the raw materials. These deflected hammers are made of durable and attrition-resistant alloy. The rod-like hammers are used when encountered a fine raw material at the least volume. The impact-type hammer is used only for ultra micro pulverizing.

擊鎚 Hammers

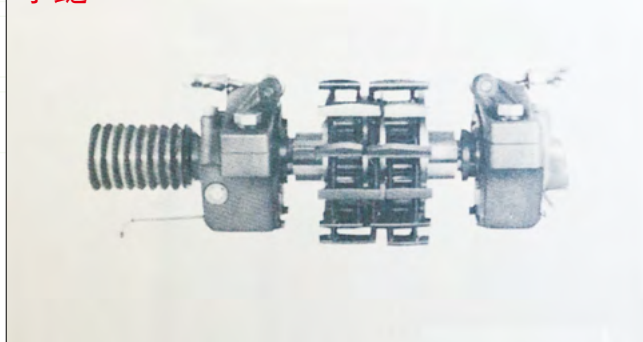

圖例這是一種可替換的排列刀具。因為當它們以高速繞著粉碎室旋轉時，覆蓋的粉碎機對原料顆粒涵蓋，呈現一系列的軋碎凸出物。排列刀能增強超微粉碎的程度，因為粒子藉著軋碎機凸出物的衝擊力而能產生真正的爆炸。這些排列刀是抗磨蝕的堅硬鋼材所製成的。

An exchangeable hammer with liners arrayed is shown in the figure. When gyrating around the grinding chamber at high-speed, its multiple deflector liners contained in a cover fitted to the pulverizer will comminute the grain raw materials by its high-spot in series. The arrayed liners can enhance the degree of micro pulverizing by virtue of a real explosion from the particles themselves when exerted the impact force from the high spots of grinder; and these arrayed liners are made of attrition-resistant rigid steel.

維護濾網 Retaining Screens



圖例就是應用在衝力型微粉碎機上的一種基本型維護濾網，濾網型式的選擇視原料特性及生產需求的純度而定。粒徑大小是在粉碎室中由擊鎚及排列刀將原料粉碎至所需要的程度而定，非由濾網所能決定。

A fundamental form of retaining screen used in the impact-force type micro pulverizer is shown in the figure; the selection of screen type depends on the characteristics of raw materials and the purity needed by production. The particle size is not determined by the screen; instead, it is determined by the required degree that hammers and the arrayed liners will comminute the raw materials inside the grinding chamber.

· 效率與衝擊力：

每部衝力型微粉碎機的生產製造均考慮其經濟性，所構成衝擊力的每一單位，均做為節省價值空間之用。

· 保養清洗容易：

因特殊設計能輕易地使各零件在需要檢測或保養清洗時能快速而容易。

· 縮節人力成本：

任何機械操作均需某種程度的智慧型管理，但本機的操作則可安心交給非專業技工，即使長時間機械運轉也無需擔心！

· 穩定性的製造：

當本機製造產品時即能不停地運轉，只須稍留意運轉有無異常便能維持產能不變，且本機可 24 小時運轉製程始終如一。

· 售後保固服務：

本機售後品質保證，且敝公司備有實驗室可代客測試粉碎原料，並提供確實資料和資訊供客戶參酌。

· Efficiency and impact force:

Every impact-force type micro-pulverizer has been taken the economical efficiency thereof into consideration for its production & manufacturing; and every constituent unit of impact force thereon will be exerted for saving the value space.

· Easy maintenance and cleaning:

A quick and easy inspection or maintenance & cleaning of each part, where necessary, is available from its specific design.

· Reduced labor cost:

Any machine operation needs an intelligent management to certain extent; yet the operation of this machine can be handled by a non-expert technician, no need to worry about running the machine for an extended period of time.

· Stable manufacturing:

Ceaselessly running machine for manufacturing products to maintain the production capacity without variation is available; just keep an eye on any abnormality arising from the operation; and operating the machine for 24 hours with consistent process is achievable as well.

· After-sales warranty service:

The after-sales quality of machine is guaranteed; and our company has laboratories available to test the comminution of raw materials for customer and provide customers with the exact data and information for consideration and reference.

附脈衝式集塵機之衝力型微粉碎機
MICRON PULVERIZER WITH PULSAIRE COLLECTOR

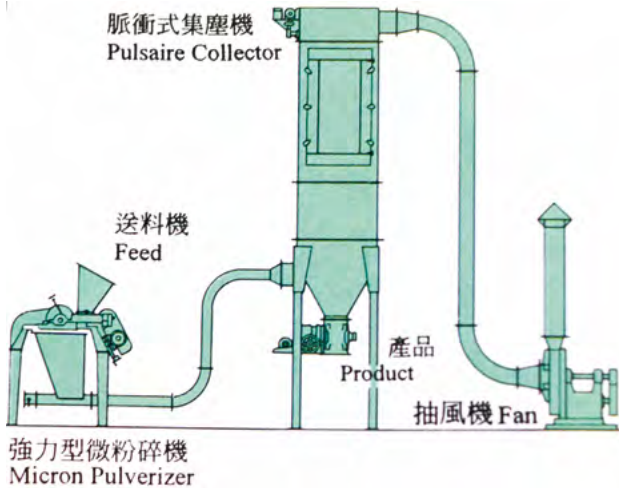

圖例是一種已粉碎原料系統，它由粉碎機排出並由脈衝式集塵機收集的。脈衝式濾過集塵機在該系統中以高濾過率提供一種持續運作的壓力，來確保粉碎機在最大能量狀態中，能穩定而連續的運轉。

A raw material pulverizing system is shown in the figure, the pulverized materials are discharged from the pulverizer and collected by the pulsaire collector. The pulsaire filtration collector is to provide a continuous operating pressure with high-filtration rate within the system to ensure a stable and continuous operation at its maximum energy state of pulverizer.

附載空氣分級機及脈衝式集塵機的衝力型微粉碎機
MICRON PULVERIZER WITH MICRON SEPARATOR
AND PULSAIRE COLLECTOR

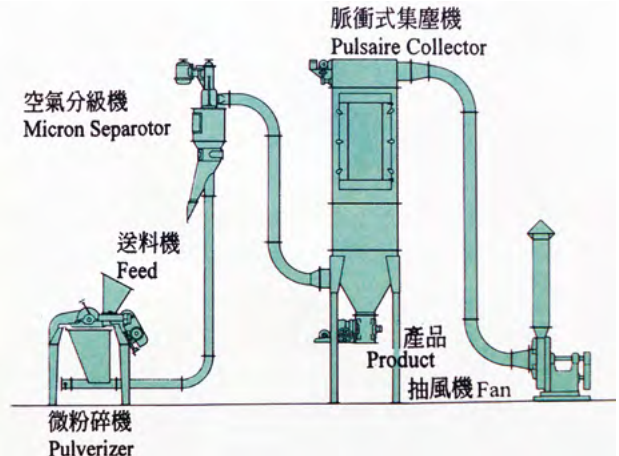

藉由附載空氣分級機是最可靠的分級器，衝力型微粉碎機能大量製造一致性的細粉粒產品。被旋出的不合格細粉粒則回到衝力型微粉碎機的另一管道，或被排於範圍之外。只有完好的粉粒會被收集在脈衝式濾過集塵機內。因此在粉碎機內能消除被過度粉碎的現象。這樣結果能使能量真正增大，衝力型微粉碎機的磨耗損率也能大幅降低。

As aided by the air classifier, the most reliable classifier, the impact-force type micro pulverizer is able to massively manufacture the fine powder and granule products with consistency. For those nonconforming pulverized particles, they will be backed out to another channel of the impact-force type micro pulverizer; or discharged out of the range. Only the conforming powder particles will be collected by the pulsaire filtration collector. Thus, the over-pulverizing phenomenon inside the pulverizer can be eliminated, and the energy can be truly magnified while the wear rate of the impact-force type micro pulverizer can be largely reduced.

空氣分級超微粉碎系統

ACM Ultra Fine Pulverizer System

空氣分級超微粉碎機集粉碎，分級兩大功能於一機，當原料送進粉碎室，經過粉碎盤高速離心力碰撞到環狀排列刀而粉碎，再以氣流通過導流環的外側送到分級室分級，過細的粉體通過分級葉到集塵機收集，其餘粗粉則從導流環的內側回到粉碎室繼續粉碎。不需停機而經由分級葉轉速的調整可得粒度分佈範圍集中的粉體，因採用無網無篩的空氣自動分級方式，且有大風量通過粉碎室，所以粉碎溫度被有效控制，對不耐熱物質最具適應性，本系統係採用連續密閉式操作，故亦無粉塵外洩問題。

ACM Ultra Fine Pulverizer combines two major functions of grinding and classification in one machine. When fed into the Pulverizer and conveyed through the Grinding Disc at a centrifugal force of high speed, pulverization of raw materials takes place by the impact of material particles on the Cutters arrayed in an annulus, then airflow will be drawn through the exterior of Diversion Ring to carry over the pulverized materials into the Classifier for classification. Ultra fine powders will pass through the classifying blades and reach the Bag Filter for collection while the rest of coarse powders will return to the Pulverizer for pulverization again. Powders within the concentrated extent for the finenesses distribution of particulate are obtainable by tuning the rpm of classifying blades without stopping the machine. Equipped with a net-less, sift-free auto air Classifier plus a Pulverizer with large air volume supplied, temperature for pulverization can be effectively controlled to make it most suitable for processing those substances that are not resistant to heat. The system is for continuous and hermetic operation so that the leakage of powdered dusts can be avoided as well.



外型圖 Outline diagram

構造圖 Construction Diagram

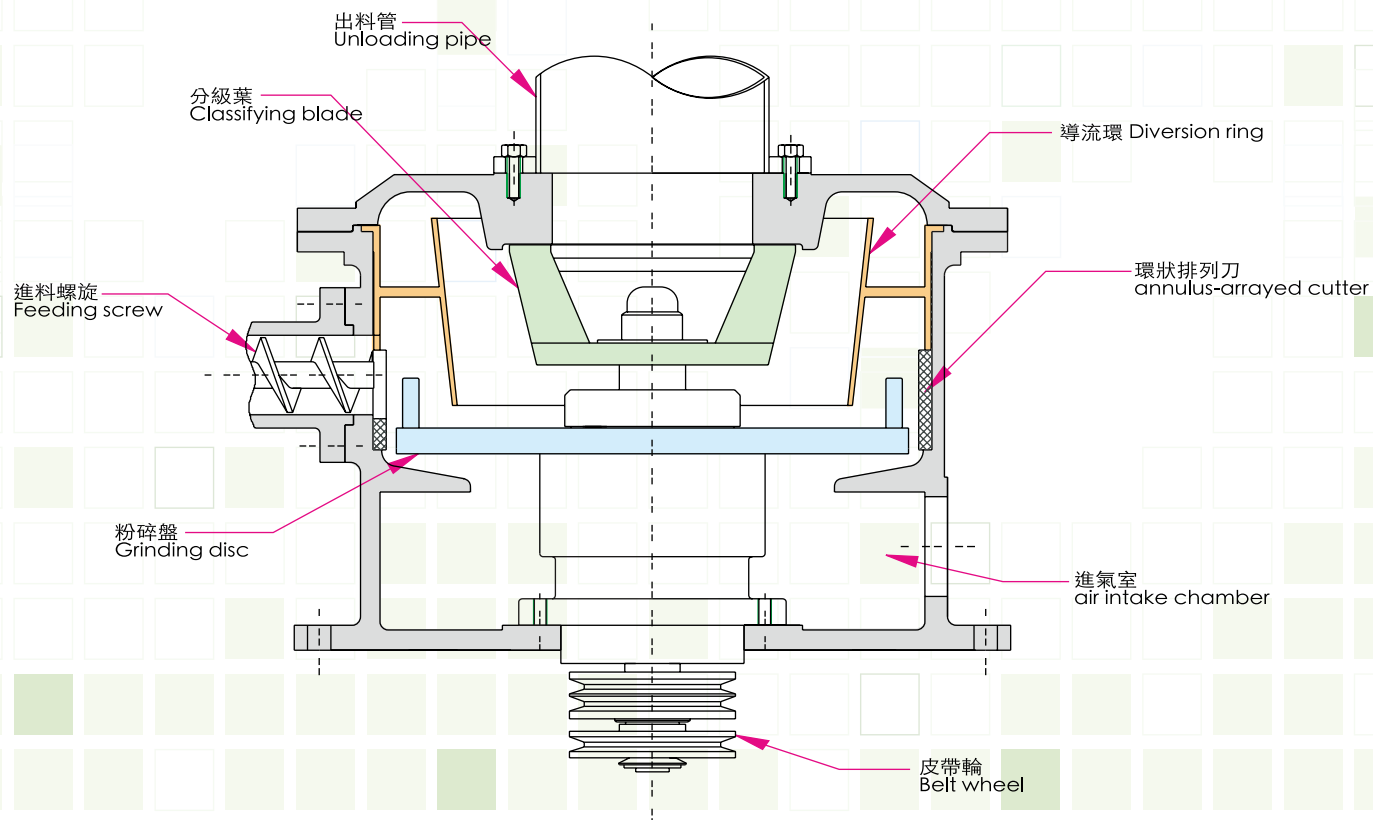

規格 Specifications		型式 Model	ACM-3	ACM-5	ACM-10	ACM-20	ACM-30	ACM-60	ACM-75	ACM-100	ACM-150	ACM-200
粉碎馬力 Pulverizer Hp	HP		3	5	10	20	30	60	75	100	150	200
粉碎轉速 pulverizer rpm	RPM		10000	10000	7000	5200	4200	3000	2600	2200	2100	1850
分級馬力 Classifier Hp	HP		1/2	1	1	3	5	10	15	20	25	50
分級轉速 Classifier rpm	RPM		5000	5000	4500	4000	3000	2700	2600	2500	2400	2000
概略尺寸 roughing-in dimension (mm)	L		1000	1000	1200	1300	1600	2600	2600	3000	3000	3600
	W		1100	1100	1300	1350	1700	2800	2800	3200	3200	2700
	H		1300	1300	1500	1600	1800	2300	2300	2700	2800	3200
概略重量 approximate weight	KGs		160	180	350	600	1000	2000	2200	2500	2700	3000

空氣分級超微粉碎機 ACM Pulverizer

尺寸圖 Dimension diagram

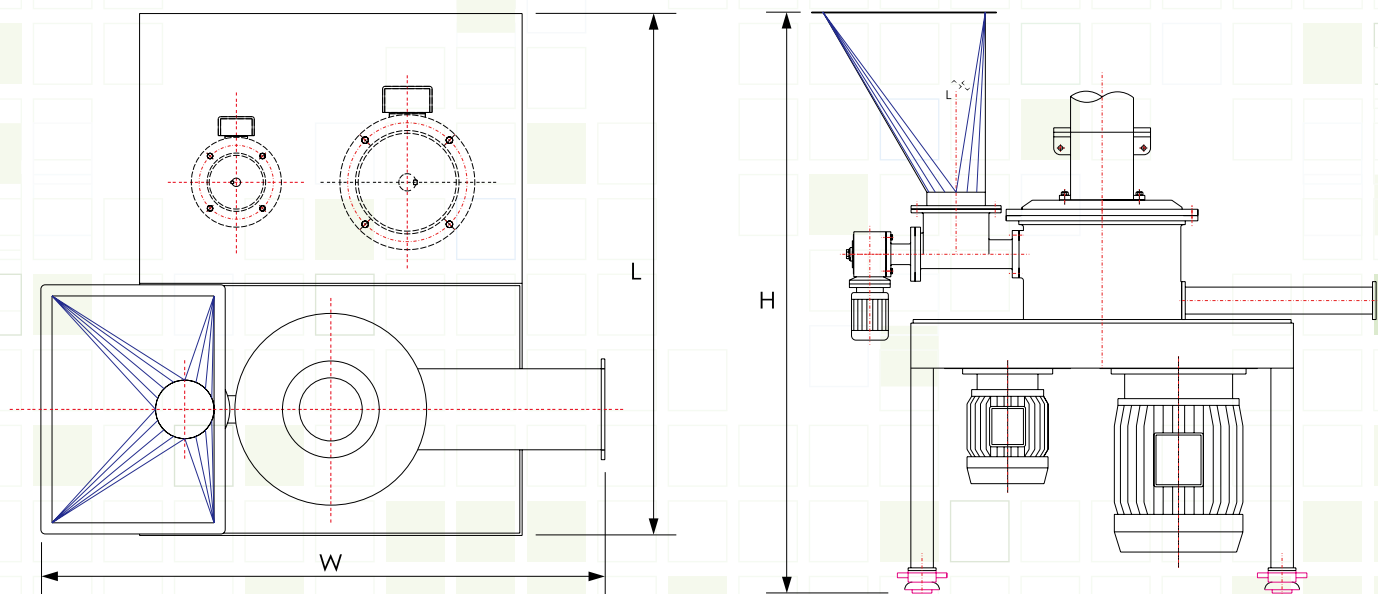

流程圖 Flow chart

直接收塵系統 Direct Dust Collection System

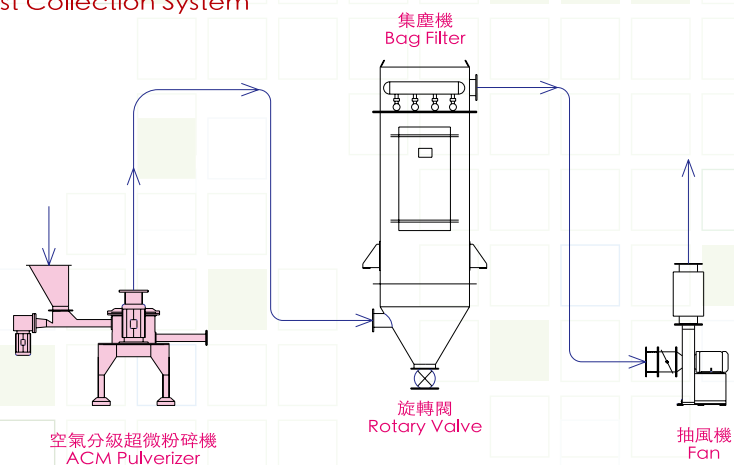

增設旋風分離器系統 Additional installation of cyclone system

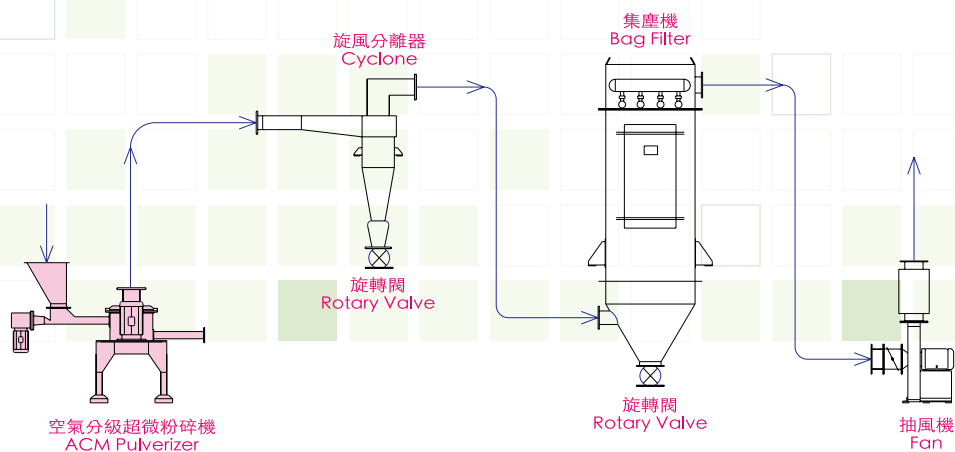

增設分級機系統 Additional installation of separator system

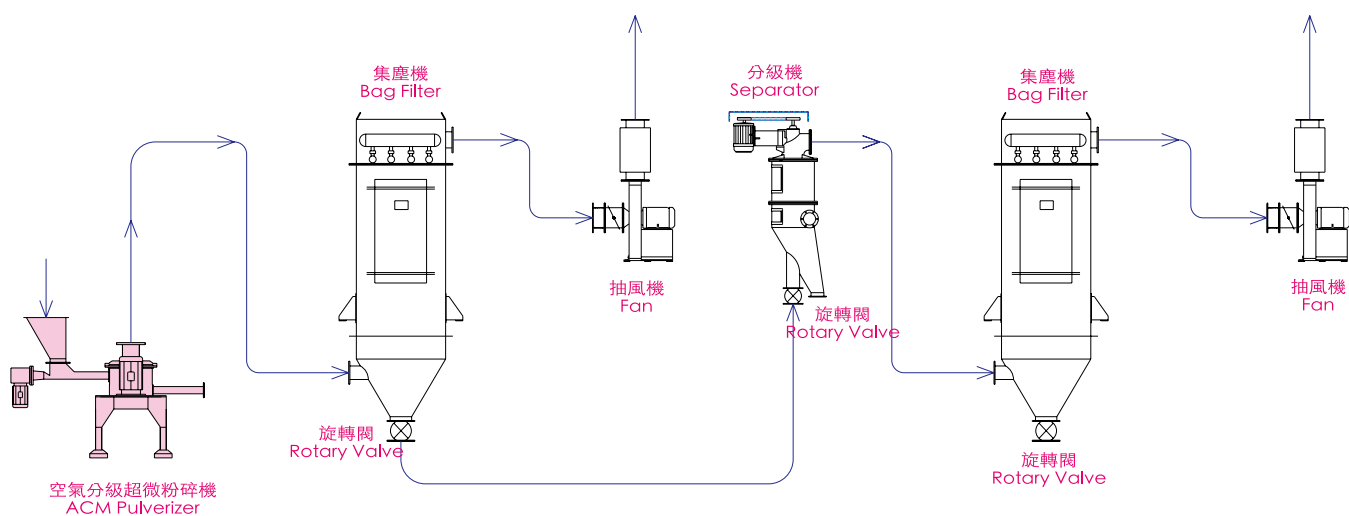

ACM-5

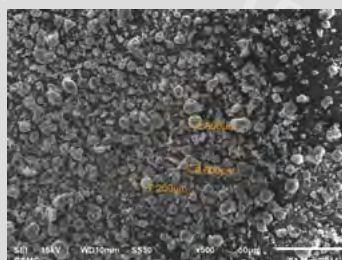
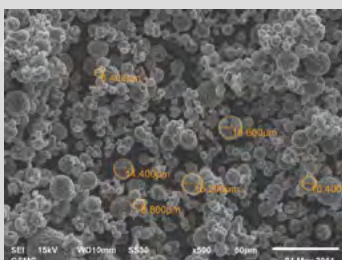
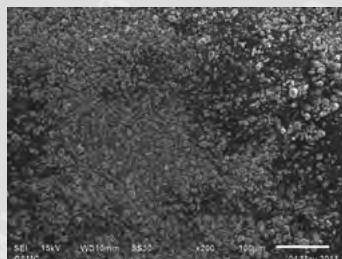
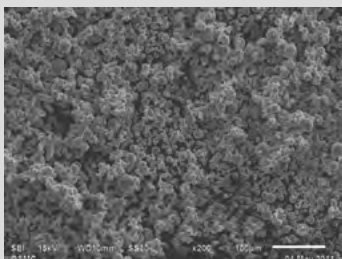
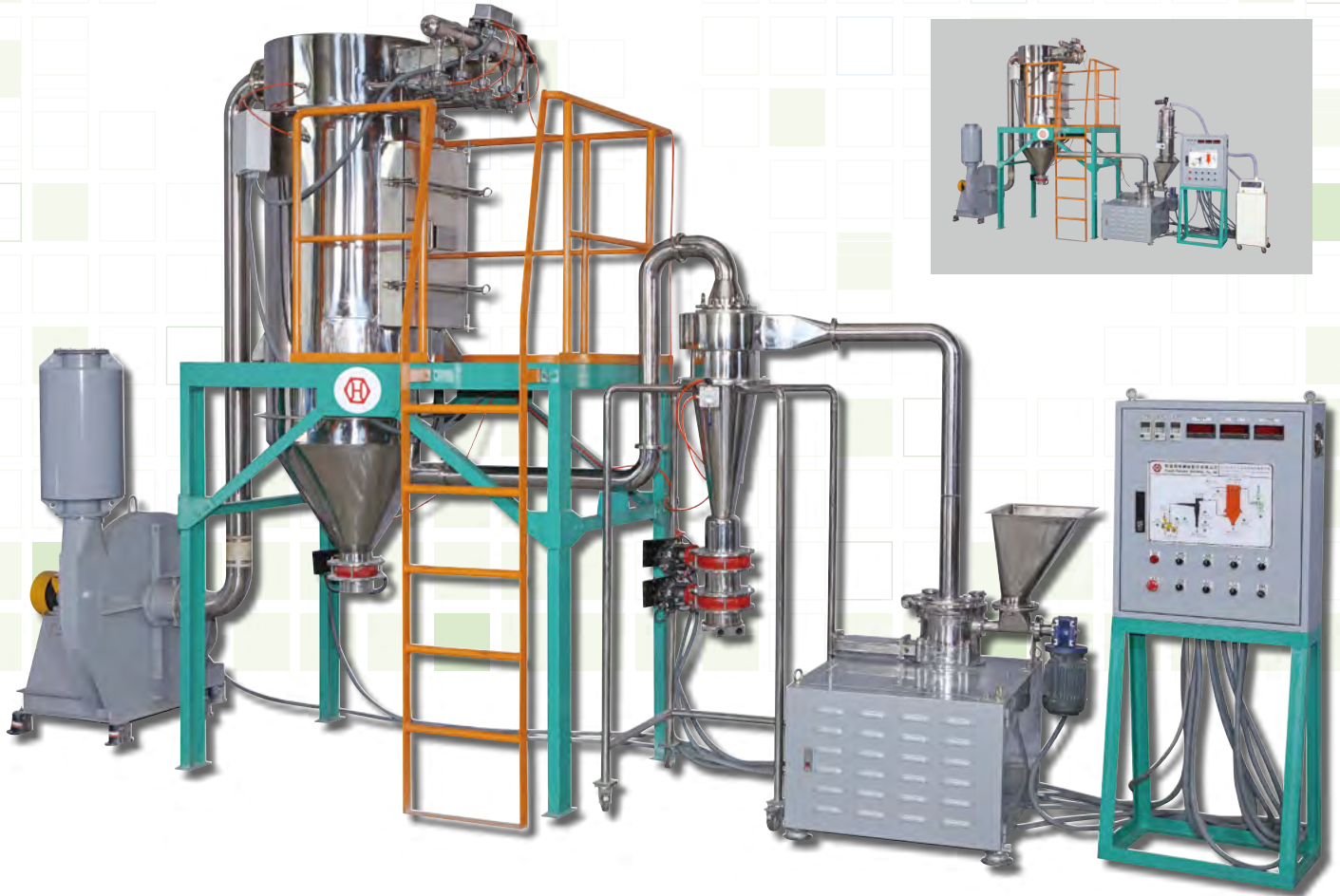

ACM-20



ACM-30





ACM-60



ACM-75



空氣分級超微粉碎系統 - 集塵機活動型

ACM Ultra Fine Pulverizer System-Movable Bag Filter



氣流式粉碎機

JET MILL

高壓空氣經由噴嘴 (Jet Nozzle) 進入粉碎室，形成高速氣流，使同時進入的原料粉末受到衝擊，原料粉粒之間互相碰撞及摩擦，達到粉碎效果，因不使用任何研磨介質，不造成污染、殘留。

High-pressure air will burst into grinding chamber through the Jet Nozzles to form a jet stream that impacts the raw material powders entering into the chamber at the same time; consequently, the powder particles of raw material will collide and rub with one another amongst themselves to achieve the comminution effectiveness; since there are no any abrasive medias used, so the comminution process will not cause pollution and residues.



安裝實例
Embodiment of the Installation





華穎公司由一群在化工、食品、製藥等業界食物工作 20 年以上之專業人士所組成，公司設于桃園縣龜山鄉復興路三段 206 號華亞科學園區內，另有一位生產基地位於台北縣泰山鄉坡雅頭路 35-6 號，提供客戶綜合粉液體工程，精密機械設備，整廠規劃設計製造及售後服務。

主要產品有粉碎機、分級機、混合機、乾燥機、集塵機、捏合機、反應槽、旋轉閥、防架橋裝置及各種輸送設備等，具有 G.M.P 等級，適用於化工、食品、製藥、電子、生化等相關產業。

本公司備有各種實驗機可供測試，歡迎來電洽詢，竭誠為您服務。

Huayin Precision Machinery operating team was made up of professionals with over 20 years experience in the Chemical, Food and Pharmaceutical Industry. The company located in No.206, Fusing 3rd Rd., Gueishan Township, Taoyuan County, Taiwan R.O.C. and also set the factory in No.35-6, Poyatou Rd., Taishan Shiang, Taipei County, Taiwan R.O.C.

We handled an extensive range of machinery equipments, such as Mill, Mixer, Dryer, Dust, Collector, Separator...etc. The equipments are all with the G.M.P. certification to be suitable for use in Chemical, Food, Pharmaceutical, Electronic and Biochemical Industry. In addition, we also give service to the customer about the Comprehensive Powder and Liquid Engineering, Precision Machinery Equipment, All Project Design Planning and After-sale Service.

And our company also will supply various experiment machines for any tests. Welcome your calling and hope the chance can to do the service for you.

